

## WORKSHOP | ABSTRACT ASSEMBLAGE PAINTINGS | LISA TRAXLER RWS Saturday 6 April 2019 10am – 4pm

### Course Description:

During this one day workshop students will make abstract collage assemblage paintings with acrylic paint. Inspired by our architectural and urban surroundings, they will look at form and shape and explore structure.

Initially students will go out and about in Chelsea collecting ideas in sketchbooks and then return to the studio at Heatherley's to prepare papers, cut and assemble the relief collages.

---

### Structure of the day:

#### *Morning:*

- Gathering inspiration for shape, form and colour in sketchbooks from the surrounding area
- Colour and shape working paintings in the studio & paper preparation for the colleagues

#### *Afternoon:*

- Cutting and assembling works with a focus on structure and form.

There will be a 40 minute lunch break, but students are welcome to continue working over this period, if they wish.

---

### About the Tutor:

Lisa Traxler RWS\* combines painting and 3D form within her practice, her vitreous enamel and steel mural was featured on national television (Grand Designs, Channel 4, 2012). Her work has been exhibited in the London Design Festival (2016 & 2017). She is also a member of the Royal Society of Sculptors as well as of course the Royal Watercolour Society.

\*Please note although RWS artists are professional artists with masses of experience and insight, they are not all qualified teachers, if this is a concern.

---

### Required Materials:

- Paper: Sheets or pad, assortment of acrylic or watercolour papers (300gsm paper). A3 size is fine.
- Paints: acrylic, gouache, inks, watercolours - bring your preference. (We will be covering the paper with large areas of paint)
- Brushes: selection of brushes (large sizes preferred, 2 - 3 inch & larger) & sponges
- Glue: glue stick for quick ideas and Matte Medium (Liquitex or Golden is good) for main work. You may find glue sticks are sufficient for this class (please bring a couple of large sized ones).
- NO spray mount, please.

### Important other Materials:

- Jam jar for water and an old plate to mix colours
- 2b pencil (or other for sketching ideas)
- sketchbook or sketching paper
- craft knife/ stanley knife
- scissors
- masking tape or frogtape
- cutting mat
- kitchen roll
- A coffee mug as Heatherley's no longer provide disposable cups, but tea, coffee and milk are available for students

---

### Other Practical Information for the Day of the Workshop

- The workshop is held at **The Heatherley School of Art, 75 Lots Road, London SW10 0RN (020 7351 4190)**
- On Saturdays there is some parking on the premises and a paid car park nearby.
- Entry to the College is through the front door and tutors and students must sign in at the office. Doors open at 9.30am for the tutor to set up, and 9.45-10am for students.
- You would be wise to bring a packed lunch as most of the nearby sandwich shops are closed on a Saturday. However, if you wish to buy food, there are two pubs within 2 minutes' walk of the school, *The Ram* on Burnaby Street, and the *Lots Road Pub & Dining Rooms* on Lots Road. There is a large subterranean café called *Jak's* also on Lots Road on the corner of the Kings Road. There are two Tescos about 10 minutes' walk away, one by Imperial Wharf Station and one on the Kings Road, going west at the Esso Garage. Please bring your own tea and coffee

cup as Heatherley's no longer provides these in a bid to help the environment. They will however provide tea, coffee, hot water and milk.

- Heatherley's is on the London Overground and their station is Imperial Wharf, which is about five minutes' walk away. [www.Tfl.gov.uk](http://www.Tfl.gov.uk) can help plan your journey and Heatherley's also has useful information on their website <https://www.heatherleys.org/contact/find-us/>
- If you are painting still life, objects found in other studios may be used.
- At the end of the day the office staff leave at 3.30pm. Classes must leave promptly and Heatherley's recommend that you have your class cleared up by 3.50. The door is locked at 4.00pm by a Heatherley's tutor, as RWS tutors do not have keys.
- The tutor will be provided with a list of students attending the course, but not their contact details.

If you are unable to attend last minute on the morning of the workshop, please contact the Heatherley's Reception (020 7351 4190) after 9.30am and they will pass on the message to the tutor. Bankside Gallery's phones will not be answered until 11am. **Please be aware we do not offer course fee transfers or refunds unless it is us who cancels the workshop.**

## Map of Local Area

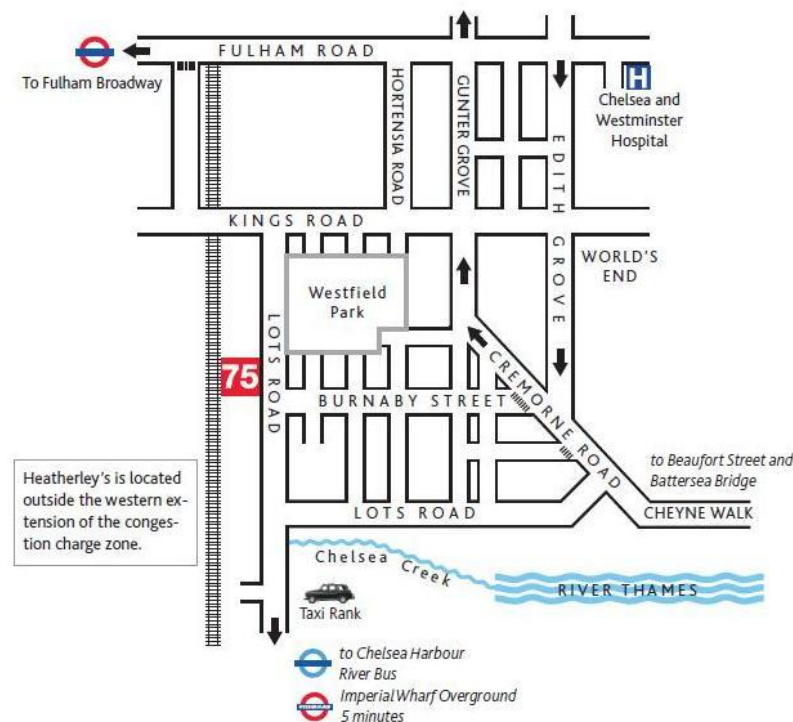

· We hope you have an enjoyable and inspiring workshop ·